

DESCRIPTION OF REVISION	BY	CHK	DATE	REV. LTR.
-------------------------	----	-----	------	-----------

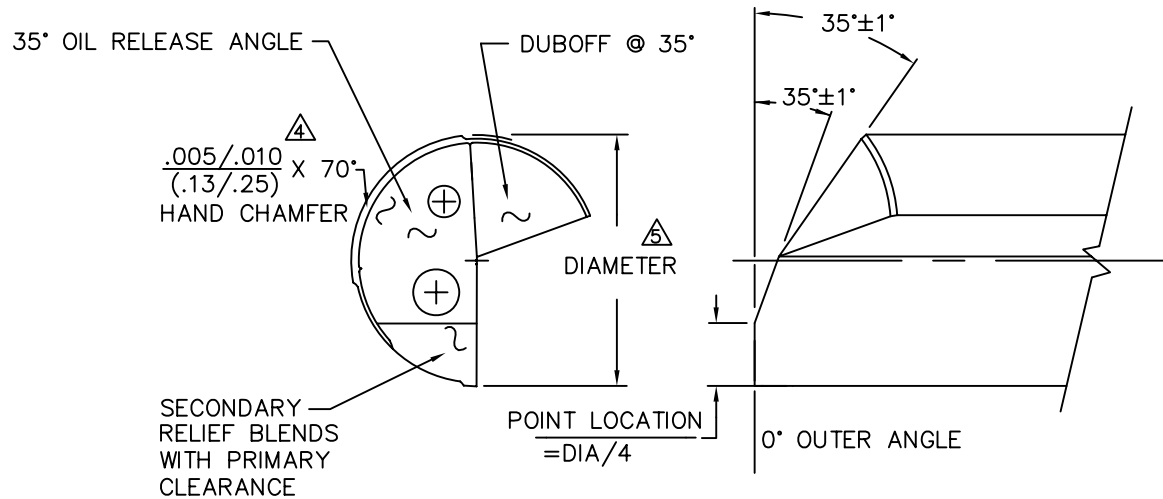

NOSEGRIND DETAIL ³
 0°-35°-35°
 @ 16° PRIMARY
 R1 RELIEF

1. ALL DIMENSIONS NOT SHOWN SHALL BE MANUFACTURERS STANDARDS.
2. ALL DIM'S IN [] ARE MILLIMETERS.
- ³ FOR NOSEGRIND SHOWN USE ELDO MODEL 'B' SHARPENING FIXTURE,
- ⁴ HAND CHAMFER AS SHOWN.
- ⁵ DIAMETER CANNOT BE MEASURED DIRECTLY DUE TO R1 RELIEF.

MANUFACTURING TOLERANCES		
DRILL DIA.	ANGLES	POINT LOC.
UP TO .375	±1°	±.002
.375 AND OVER	±2°	±.005

THIS IS A PROPRIETARY DESIGN OF ELDERADO. REPRODUCTION, MANUFACTURE OR USE OF ANY ASSEMBLY, SUBASSEMBLY, OR PART INDICATED HEREIN OR THE USE OF THE DESIGN OF ANY SUCH ASSEMBLY, SUBASSEMBLY, OR PART IS PERMISSIBLE ONLY IF EXPRESSLY AUTHORIZED IN WRITING BY DME Tool.

DO NOT SCALE DRAWING INCH DIMENSIONS ARE PRIMARY UNLESS OTHERWISE SPECIFIED		DRILL MASTERS-ELDERADO TOOL 336 BOSTON POST RD. MILFORD, CONNECTICUT U.S.A.	
INCH TOLERANCES		DESIGNER	DATE
1 PLACE	±.03	DETAILER	TITLE
2 PLACES	±.015	CHECKER	· GUNDRILL 0/35/35 COPPER GRIND
3 PLACES	±.005	RELEASED	
ANGLES	±1 deg.	SUPERSEDES	REF.
NON-ACCUMULATIVE		SCALE	SHT. OF
METRIC TOLERANCES(mm)		NONE	1 1
WHOLE NO.	± .8	DWG. NO.	REV.
1 PLACE	± .4		
2 PLACES	± .13		
ANGLES	±1 deg.		